

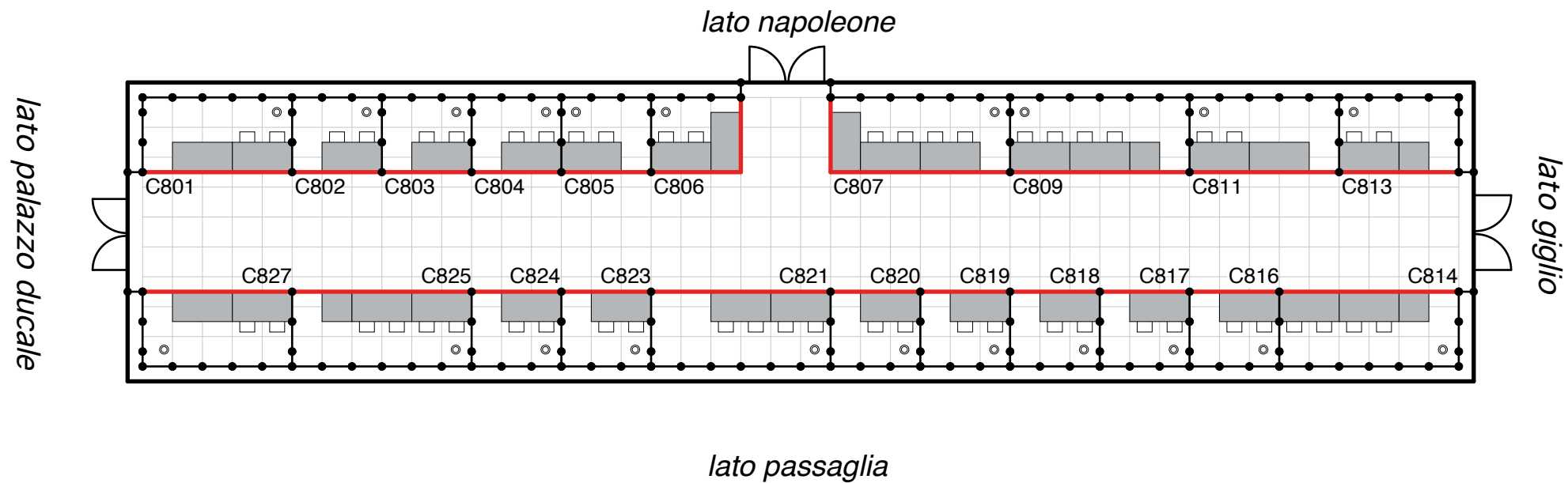

29 ott. - 1 nov. 2015

2 Pad. Passaglia
ALLEGATO GARA STAND



Lucca Comics & Games



29 ott. - 1 nov. 2015

3 Pad. Giglio

ALLEGATO GARA STAND

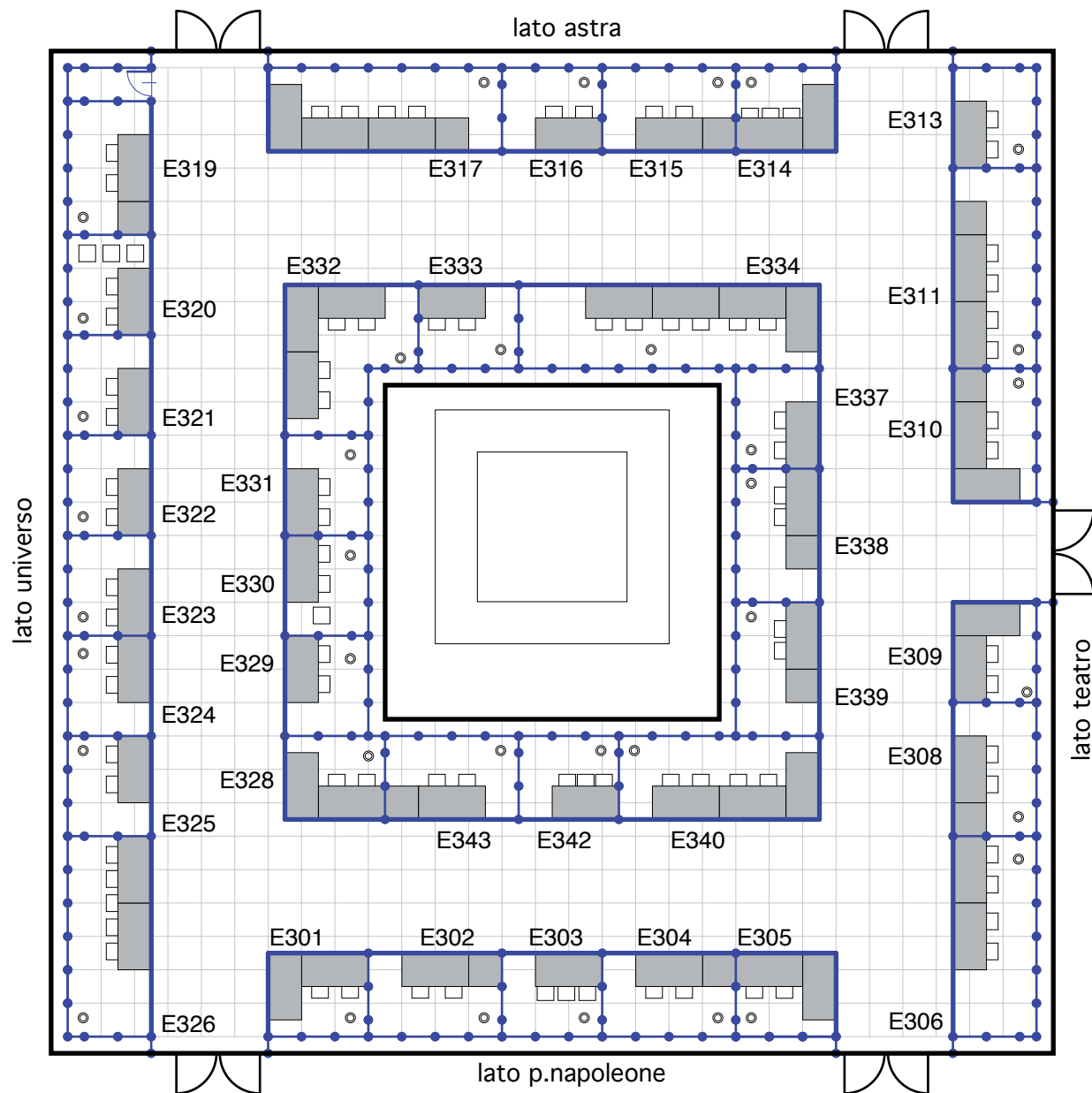

Lucca Comics & Games



29 ott. - 1 nov. 2015

4 Pad. S. Giovanni

ALLEGATO GARA STAND

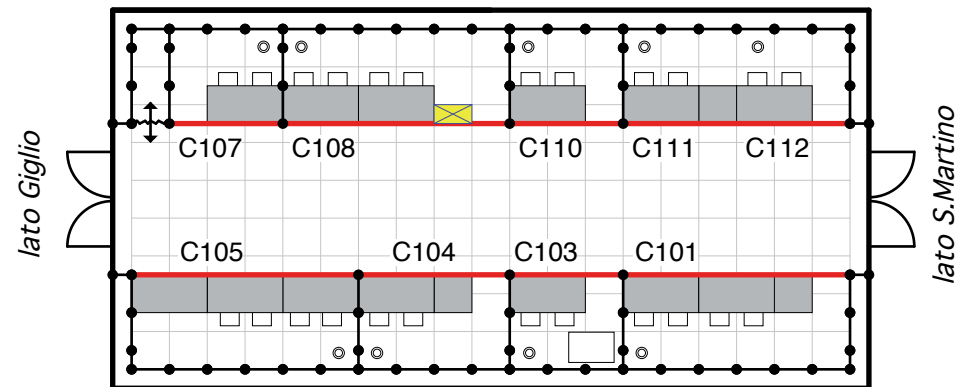

Lucca Comics & Games



29 ott. - 1 nov. 2015

5 Pad. S.Martino 1

ALLEGATO GARA STAND

via del duomo

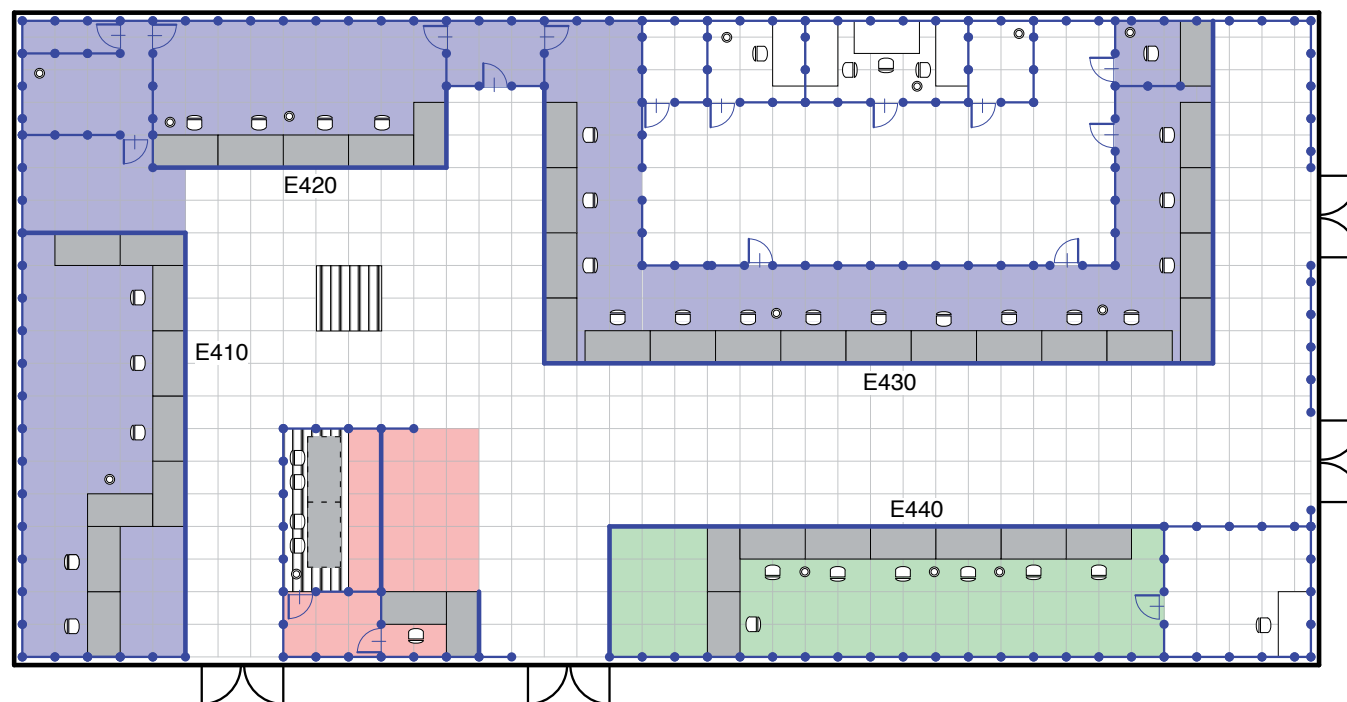

lato cattedrale

auditorium BML



29 ott. - 1 nov. 2015

6 Pad. S.Martino 2

ALLEGATO GARA STAND

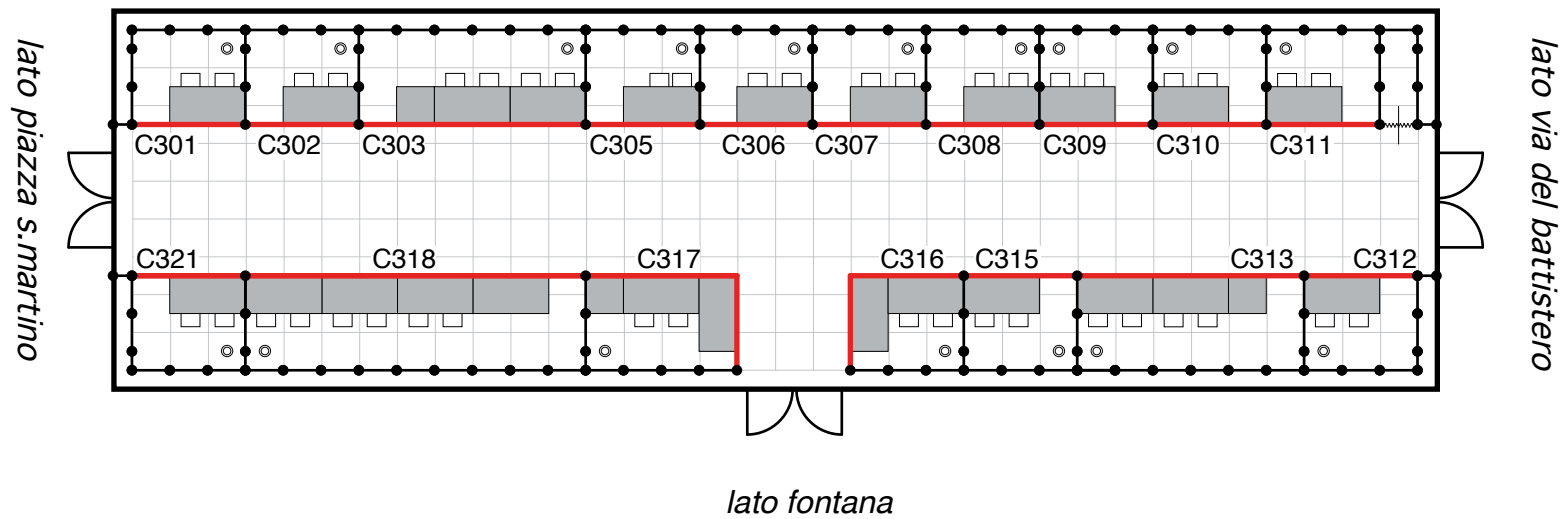

Lucca Comics & Games



29 ott. - 1 nov. 2015

7 Pad. S.Martino 3
ALLEGATO GARA STAND

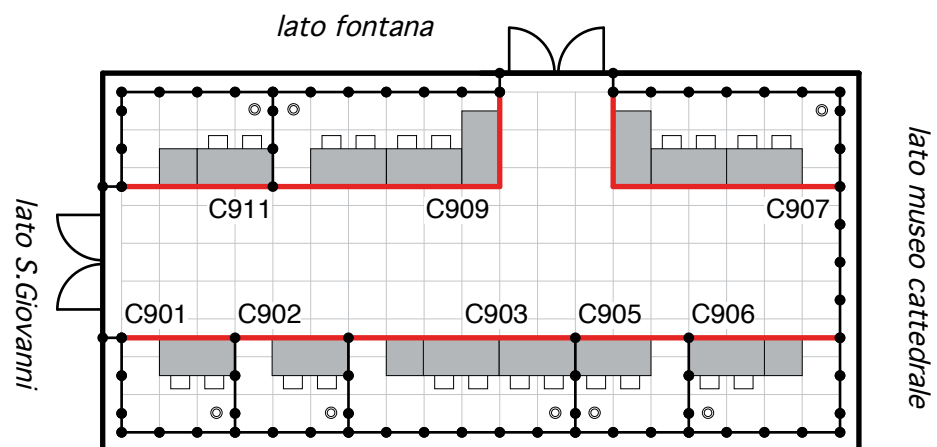

Lucca Comics & Games



29 ott. - 1 nov. 2015

8 Pad. Garibaldi 1

ALLEGATO GARA STAND

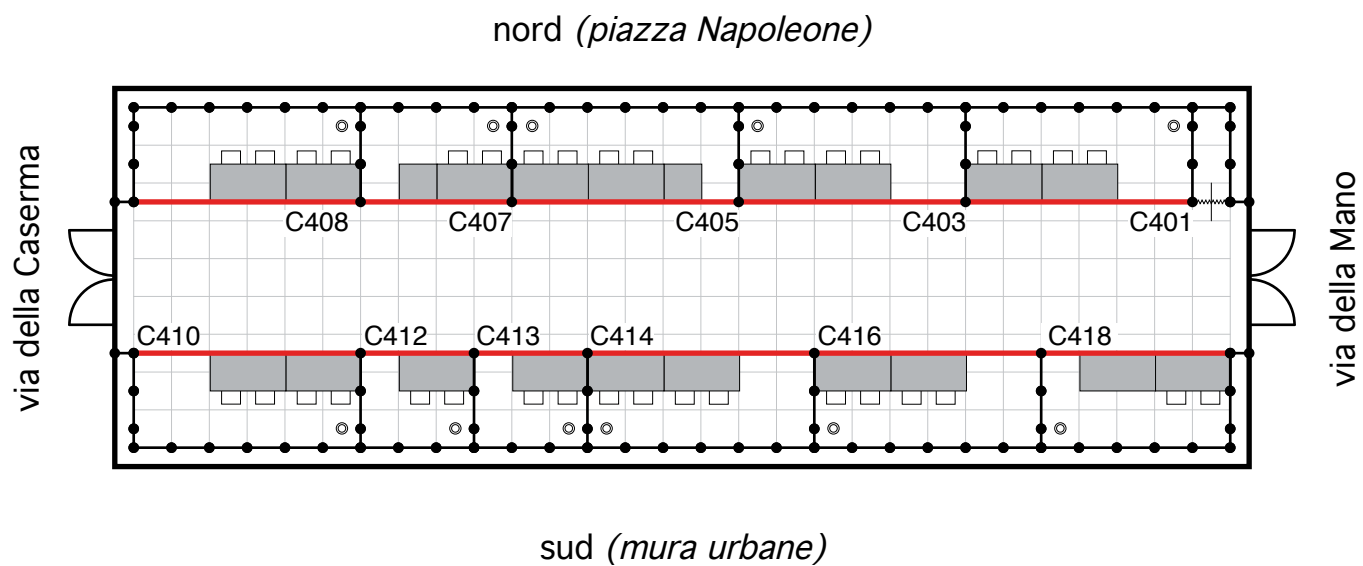

Lucca Comics & Games



29 ott. - 1 nov. 2015
9 - 10 Pad. Garibaldi 2-3

ALLEGATO GARA STAND

nord (piazza Napoleone/S.Martino)

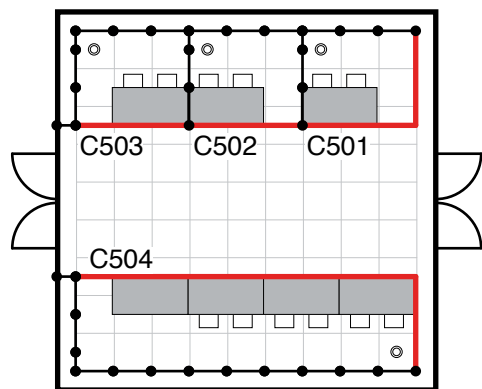

Pad. 9

sud (mura urbane)

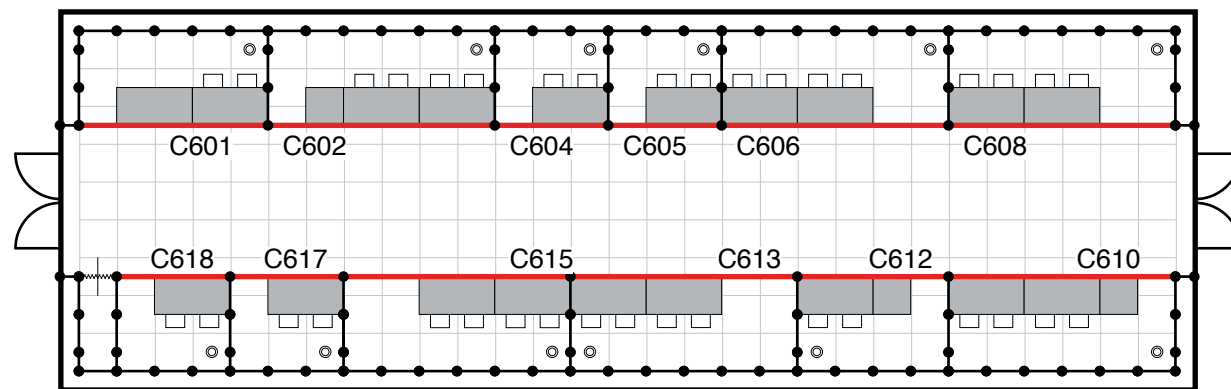

Pad. 10

via V.Veneto

via S.Girolamo

Lucca Comics & Games



29 ott. - 1 nov. 2015

11 Pad. Garibaldi 4

ALLEGATO GARA STAND

nord (piazza Napoleone/S.Martino)

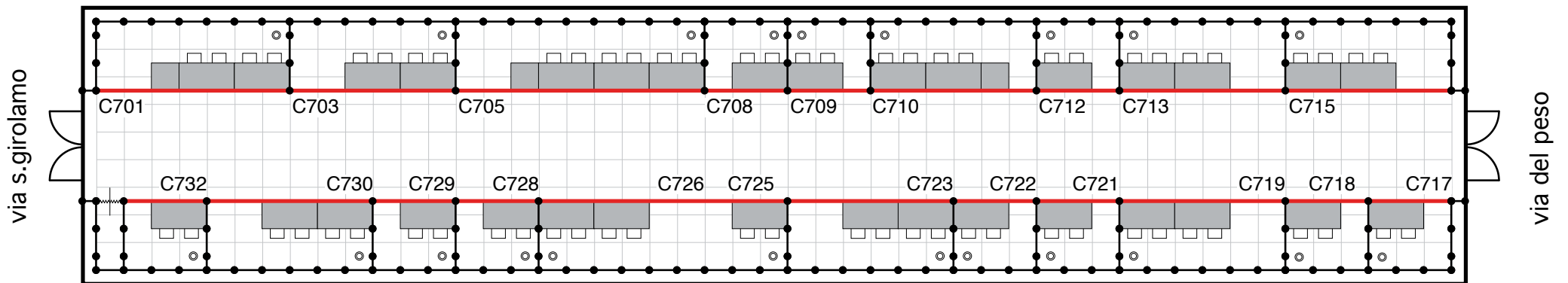

sud (mura urbane)

Lucca Comics
& Games



29 ott. - 1 nov. 2015

12 Pad. S.Romano

ALLEGATO GARA STAND

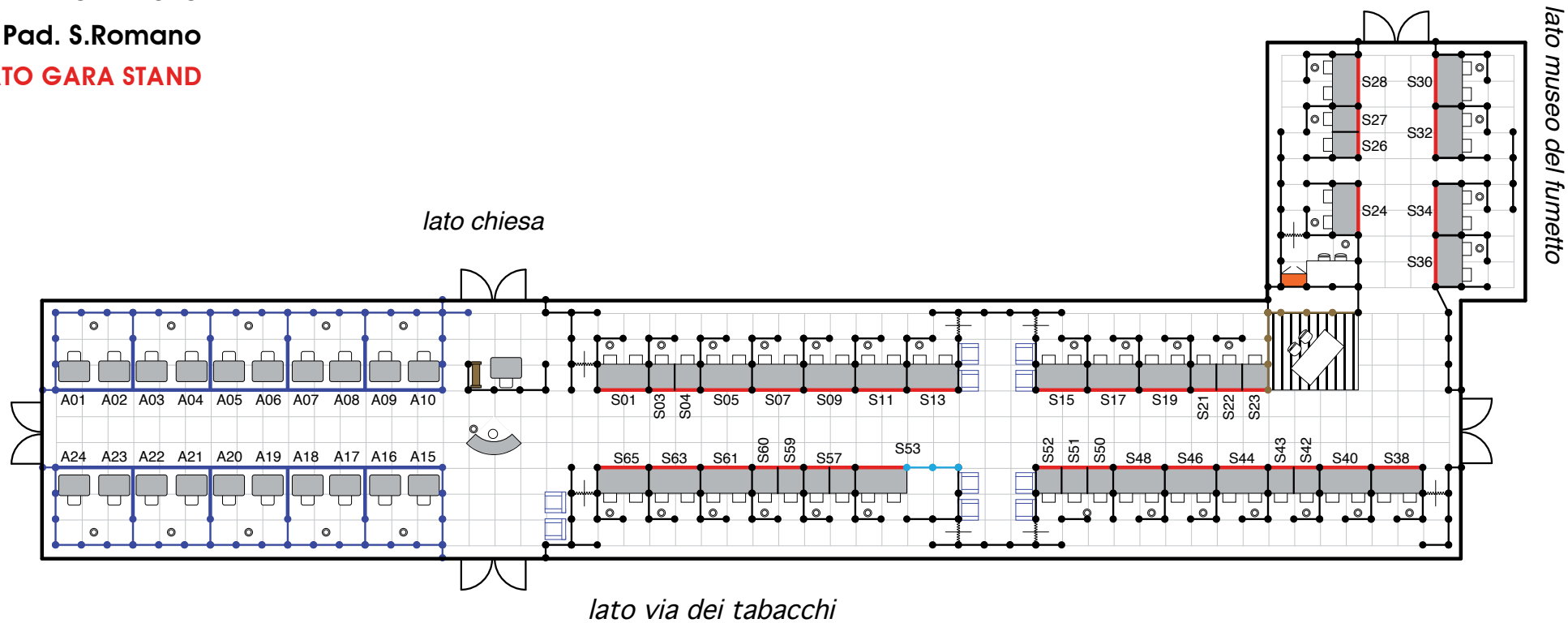

Lucca Comics & Games



29 ott. - 1 nov. 2015

15 Pad. S.Maria 1

16 Pad. S.Maria 2

ALLEGATO GARA STAND

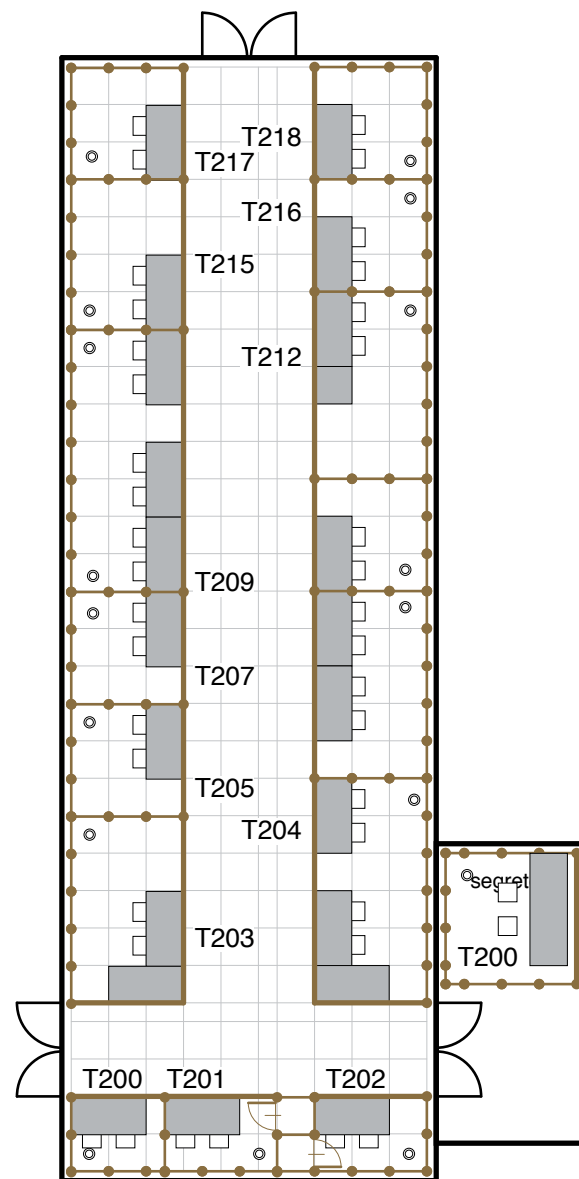

Pad. 16

rampa salita mura urbane

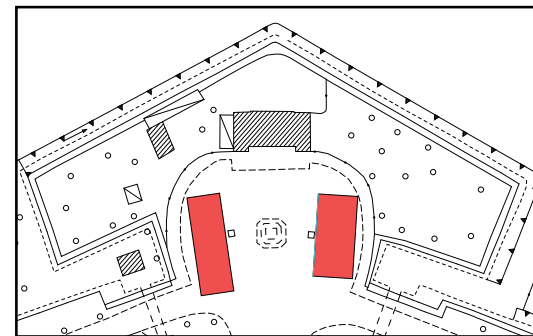

*monumento
V.Emanuele*

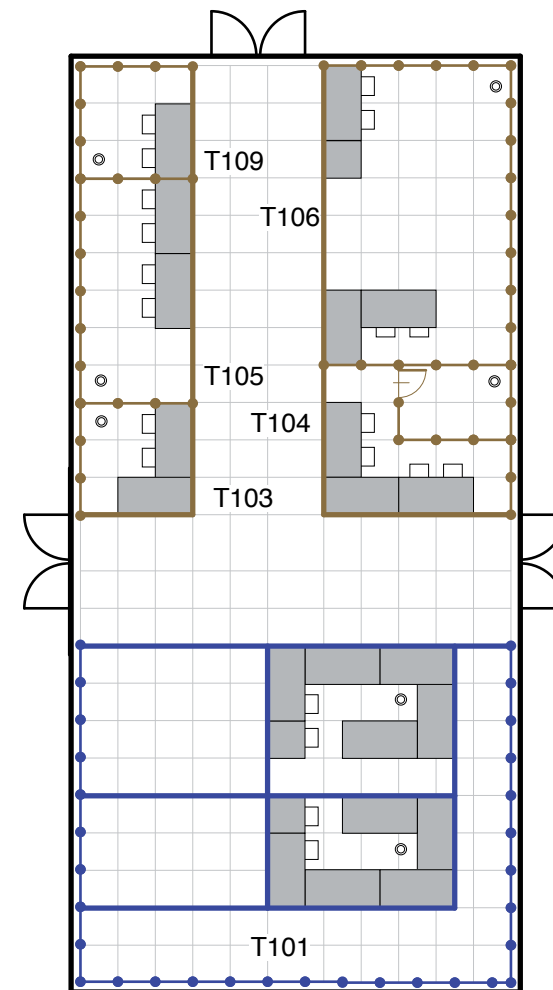

Pad. 15

Lucca Comics & Games



29 ott. - 1 nov. 2015

17 Pad. S.Paolino Palco

ALLEGATO GARA STAND

- 1** 6 tavoli 120x80
6 tovaglie tre lati
10 sedie
6 sgabelli alti
- 2** 2 banconi 300x100
6 sedie
2 cestini
- 3** 4 banconi 300x100
8 sedie
4 cestini
- 4** 12 tavoli 200x100
40 sedie
6 scaffali
5 cestini
- 5** 190 m. recinzione alta

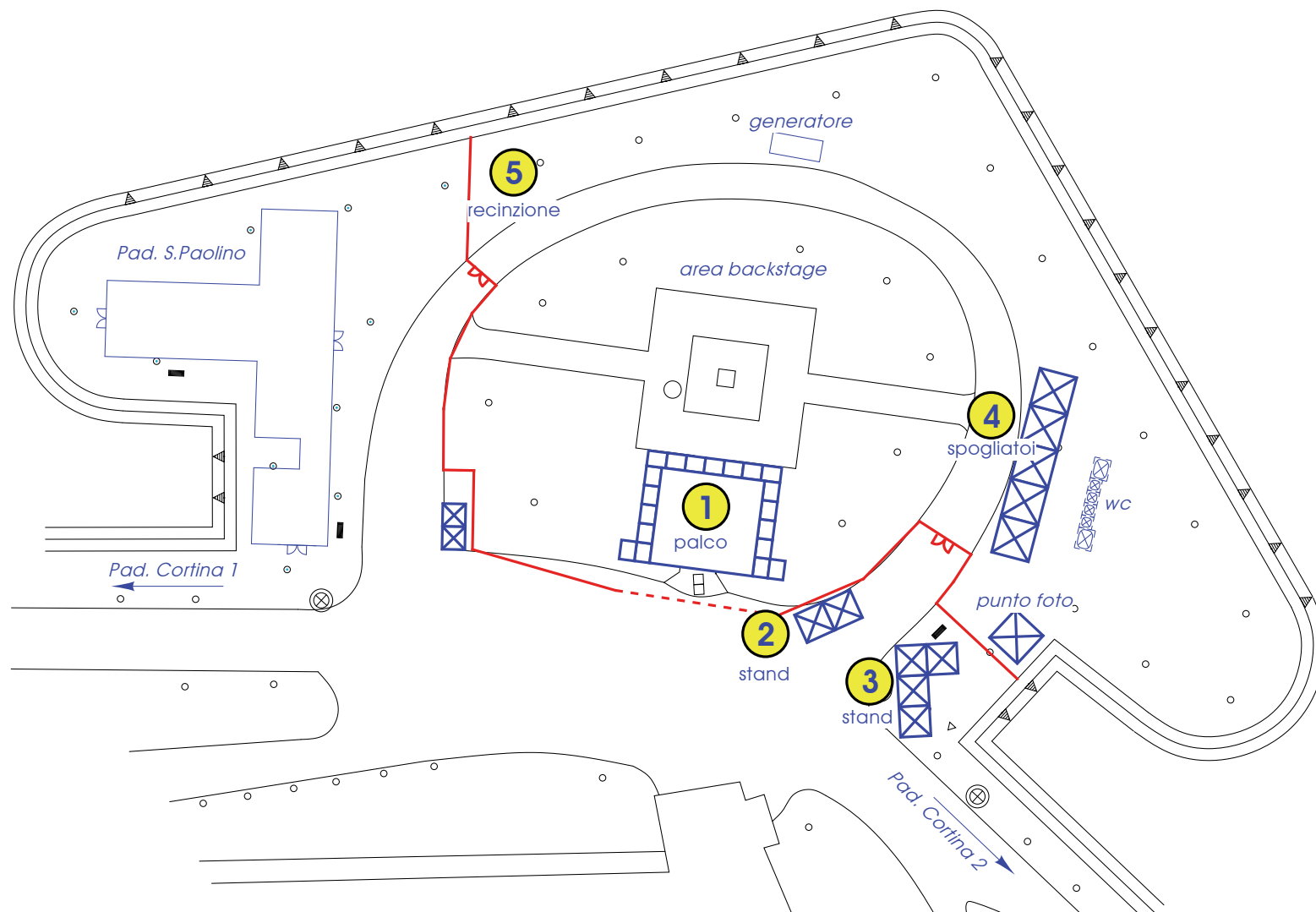



29 ott. - 1 nov. 2015
18 Pad. S.Paolino
ALLEGATO GARA STAND

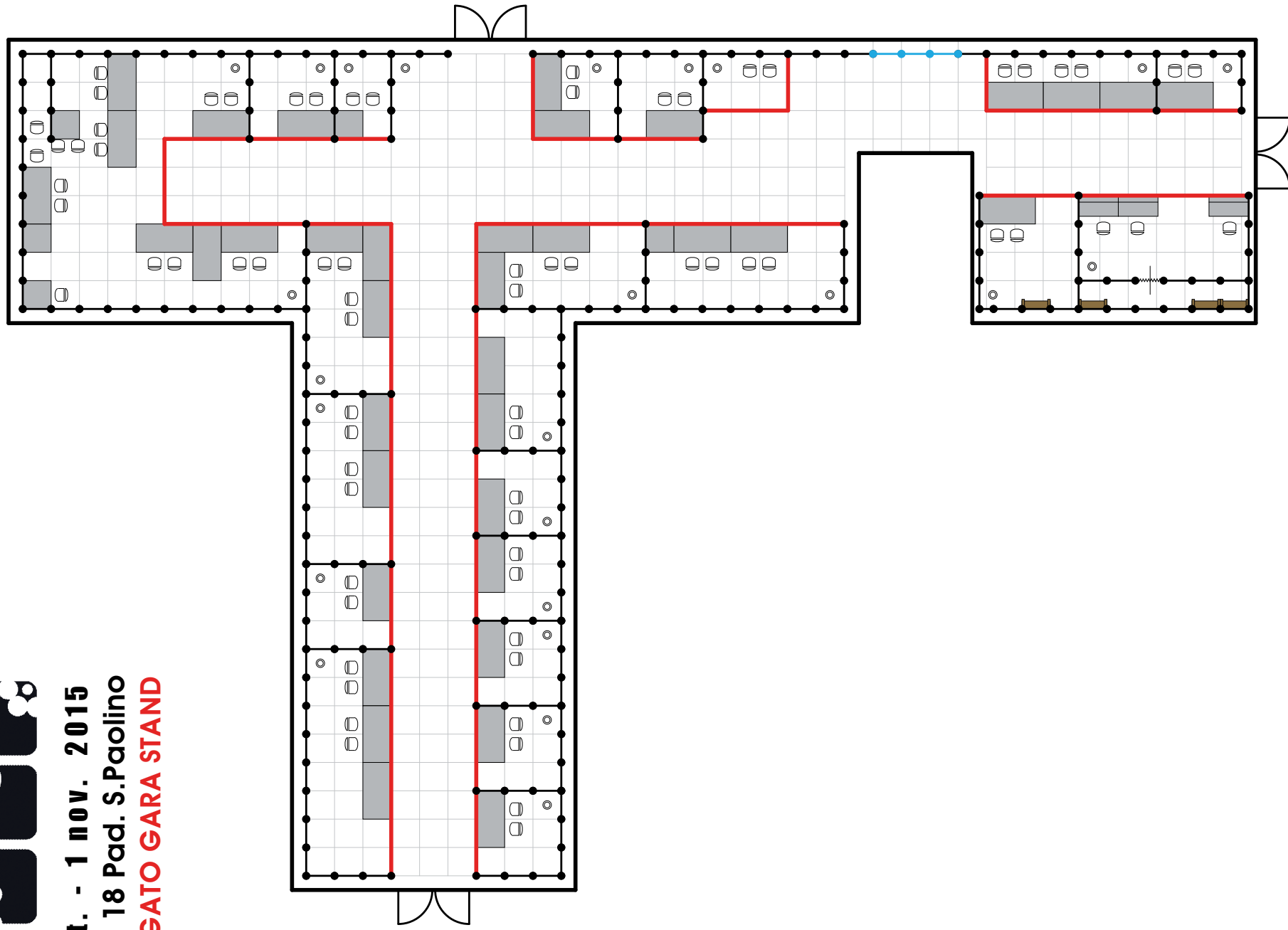

Lucca Comics
& Games



29 ott. - 1 nov. 2015

19 Pad. Cortina 1

ALLEGATO GARA STAND

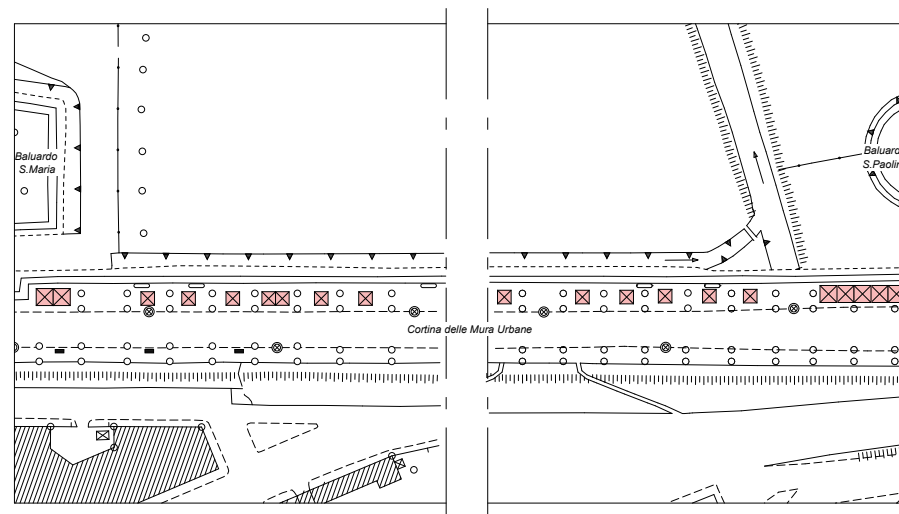

schema distributivo esemplificativo

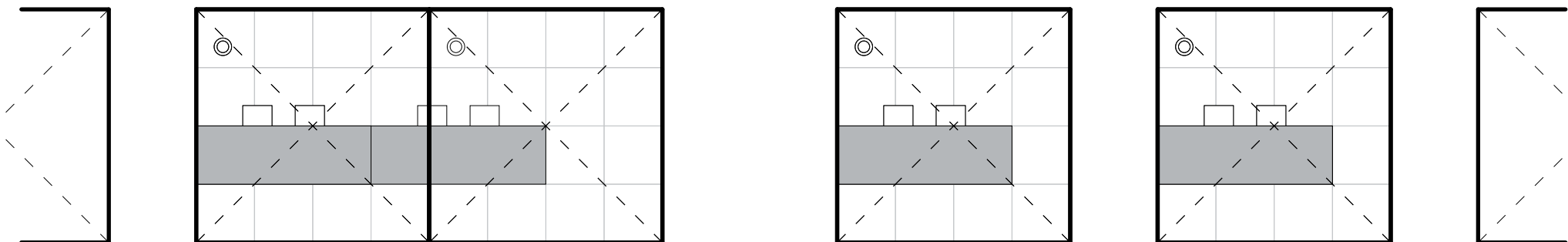

passeggiata mura urbane

Lucca Comics & Games



29 ott. - 1 nov. 2015

20 Pad. Cortina 2

ALLEGATO GARA STAND

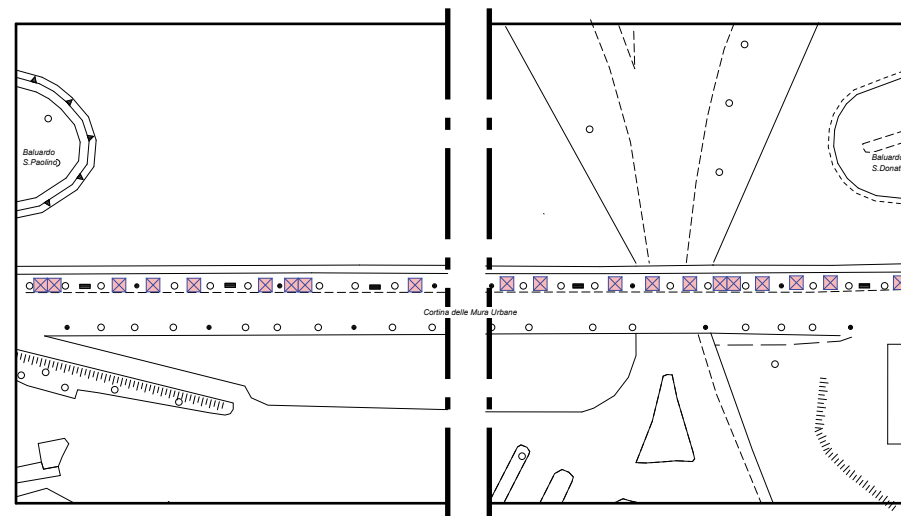

schema distributivo esemplificativo

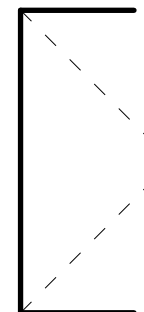
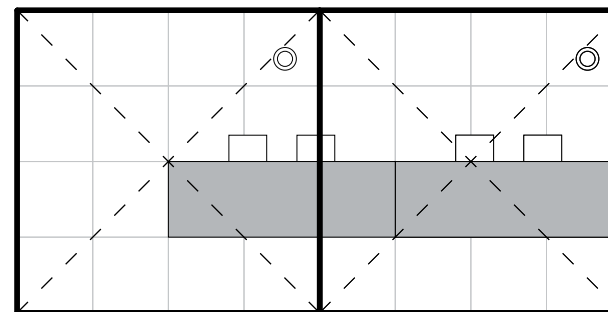
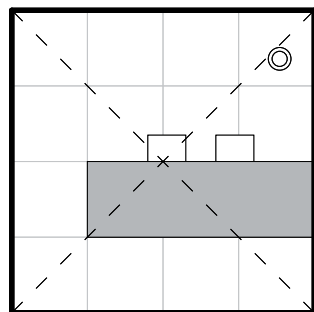
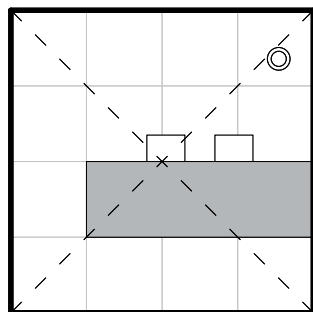
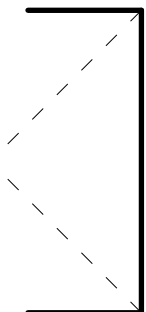

passaggiata mura urbane

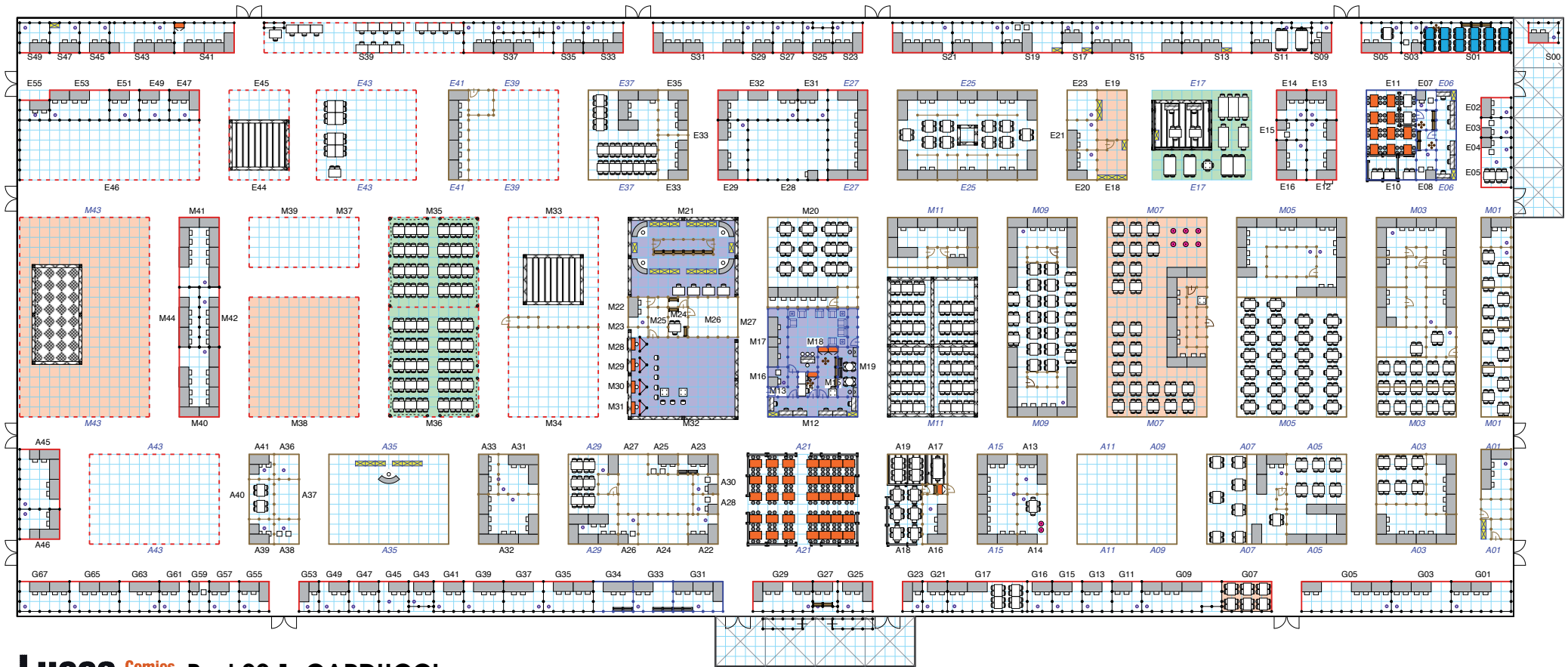



29 ott. - 1 nov. 2015
Pad. 22 2 SALA INCONTRI
ALLEGATO GARA STAND

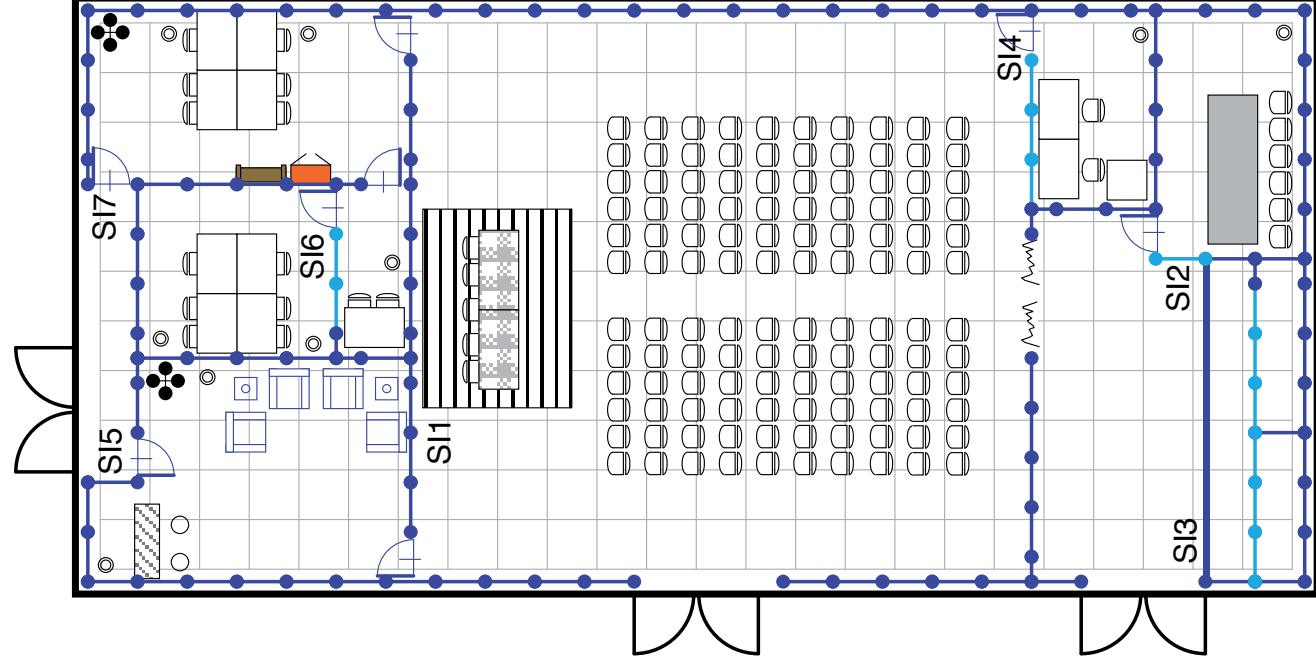



29 ott. - 1 nov. 2015

Pad. 22 3 MAGAZZINO

ALLEGATO GARA STAND

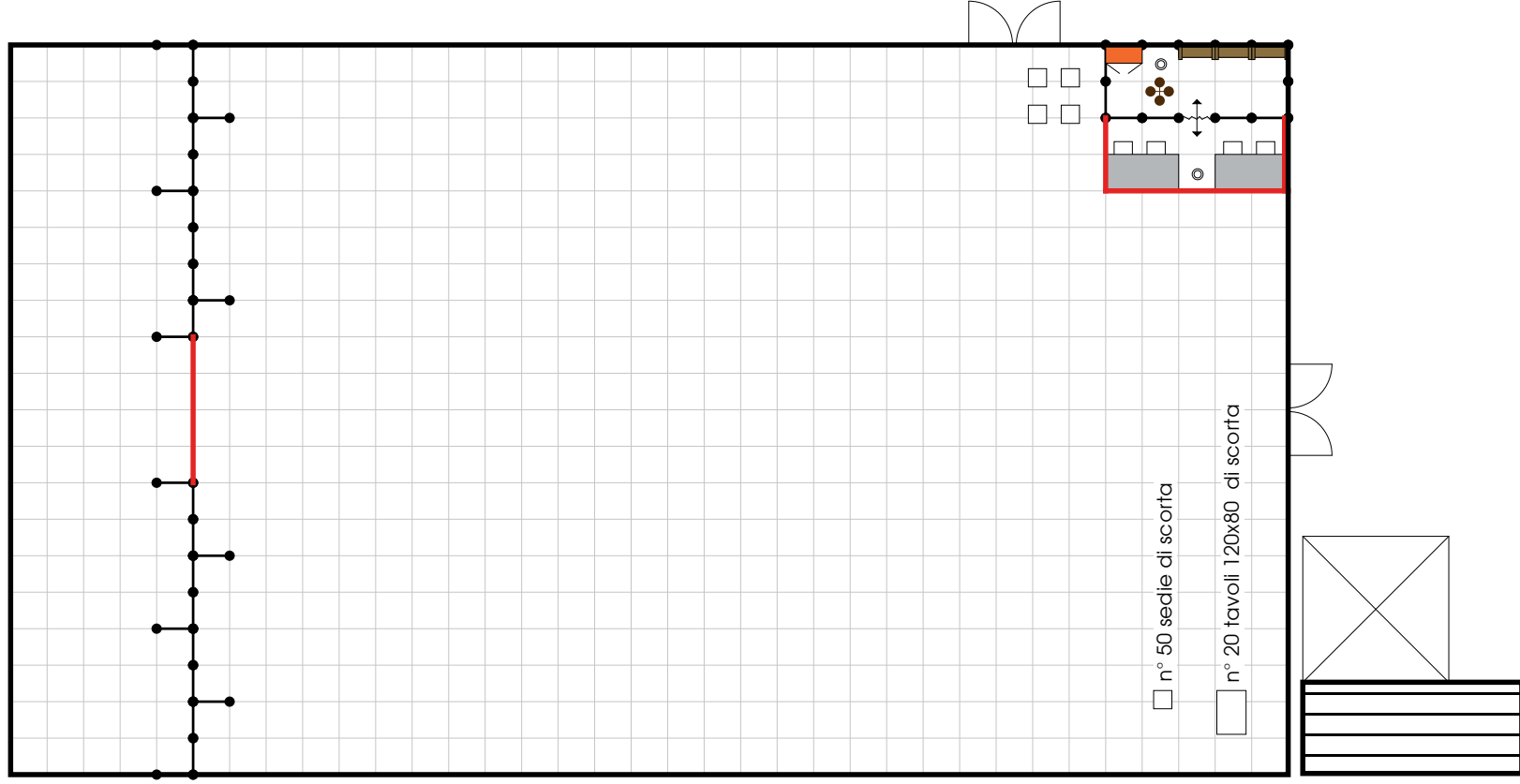

Lucca Comics & Games



29 ott. - 1 nov. 2015

28 Pad. S.Francesco

ALLEGATO GARA STAND

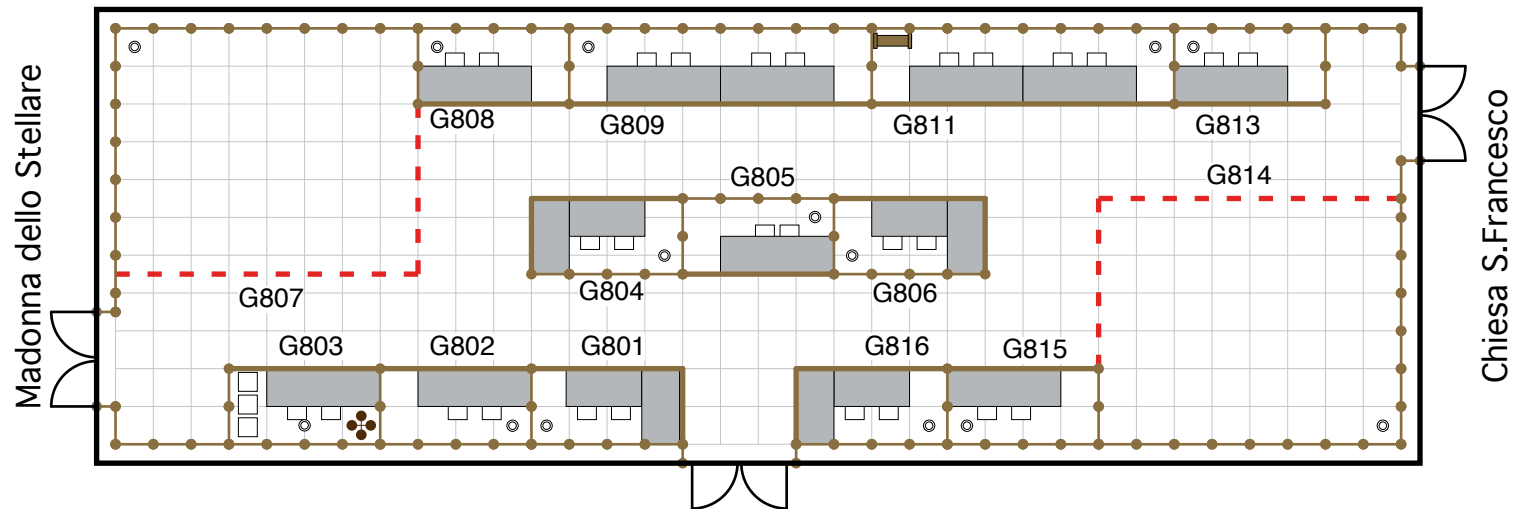

Lucca Comics & Games



29 ott. - 1 nov. 2015

29 1 Pad. Japan 1

ALLEGATO GARA STAND

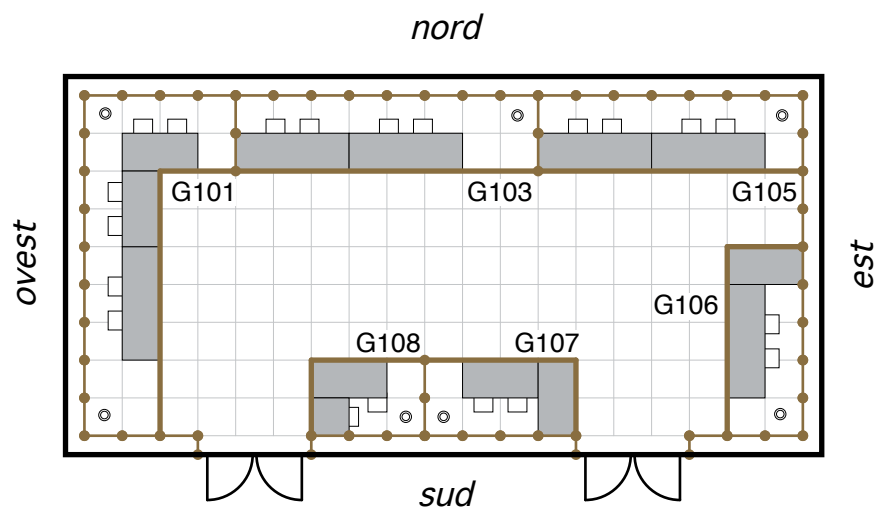
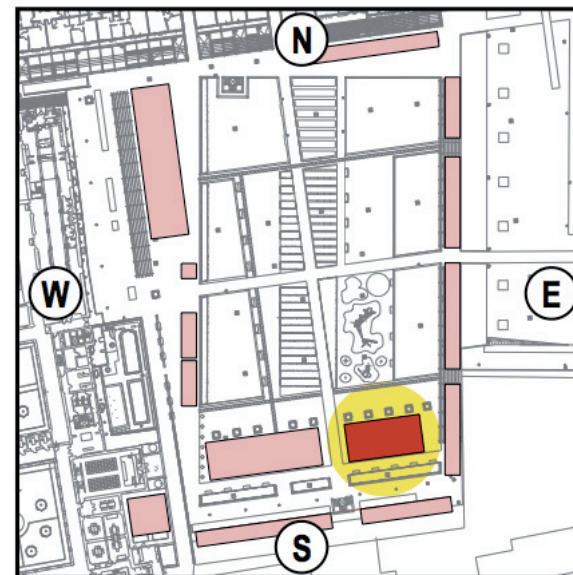

Lucca Comics & Games

29 ott. - 1 nov. 2015
29 2 Pad. Japan 2

ALLEGATO GARA STAND

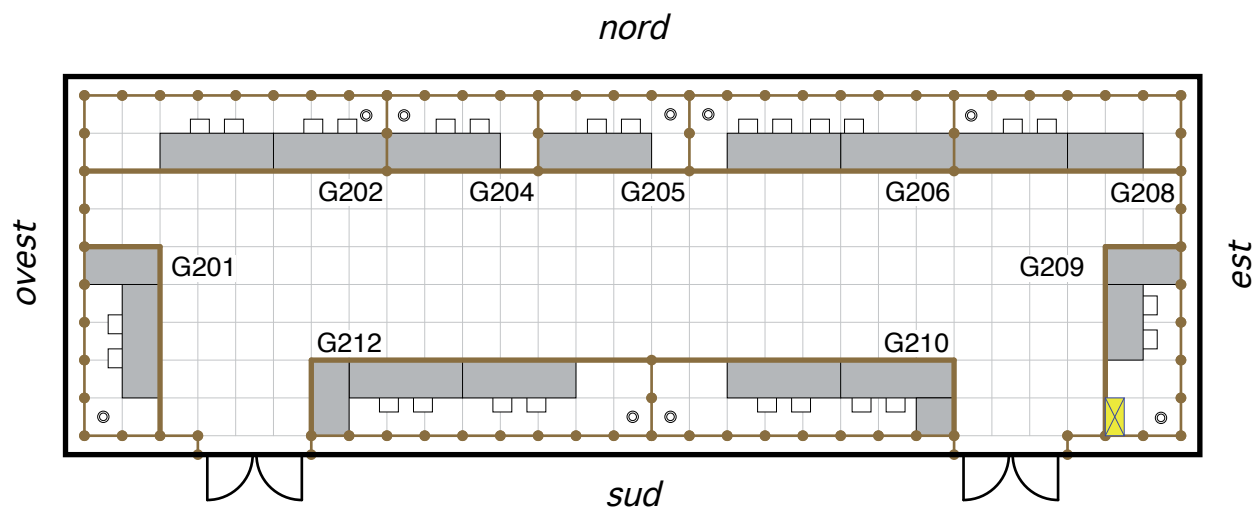
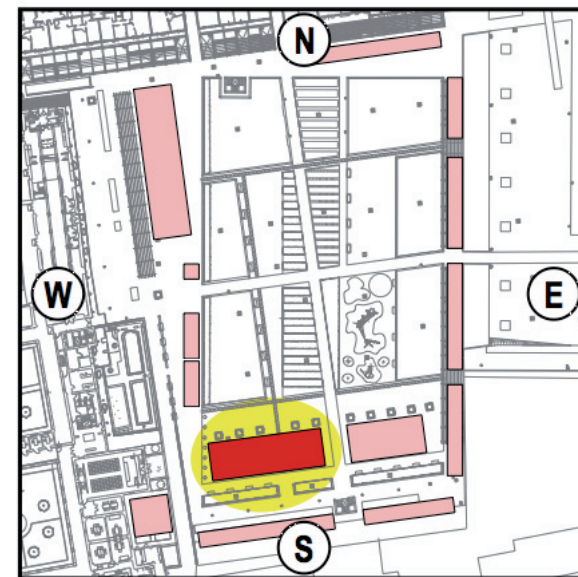

Lucca Comics & Games



29 ott. - 1 nov. 2015

29 3 Pad. Japan 3

ALLEGATO GARA STAND

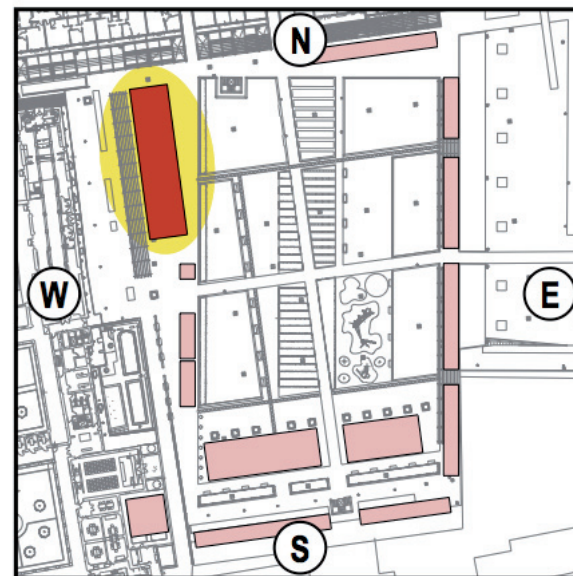

ovest



Lucca Comics & Games



19 ott. - 1 nov. 2015

29 4 Pad. Japan Nord

ALLEGATO GARA STAND

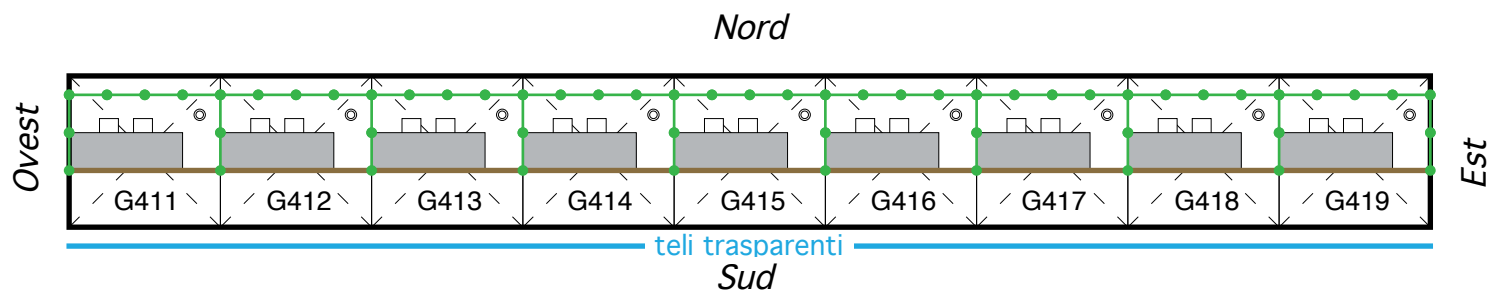
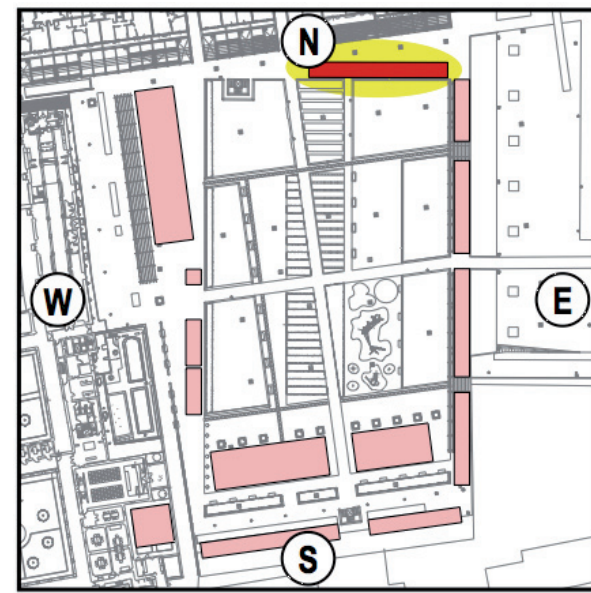



29 ott. - 1 nov. 2015
29 5 Pad. Japan Est
ALLEGATO GARA STAND

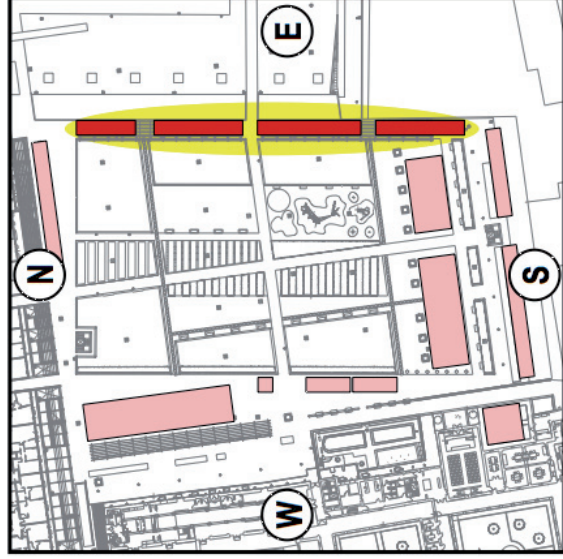

Nord

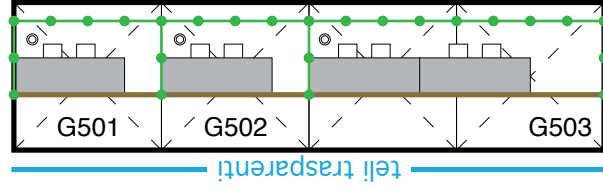

Ovest

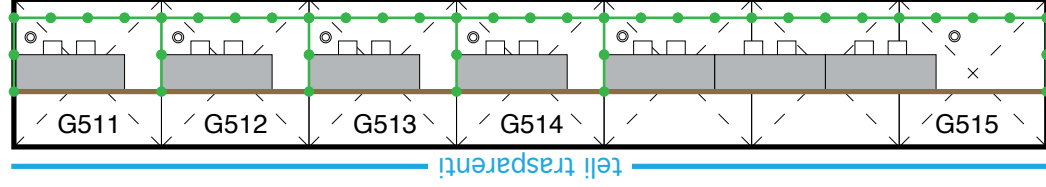
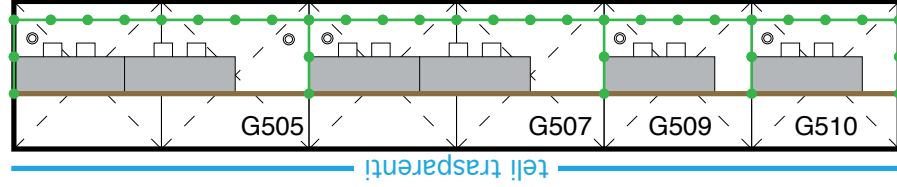

Sud

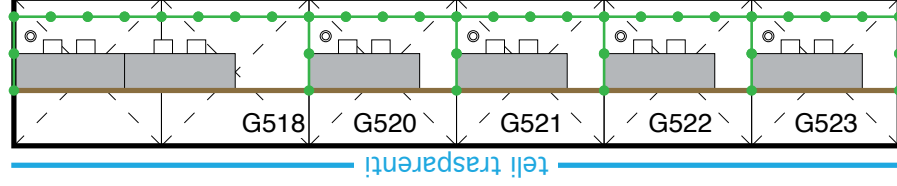

Est

Lucca Comics & Games



29 ott. - 1 nov. 2015

29 6 Pad. Japan Sud

ALLEGATO GARA STAND

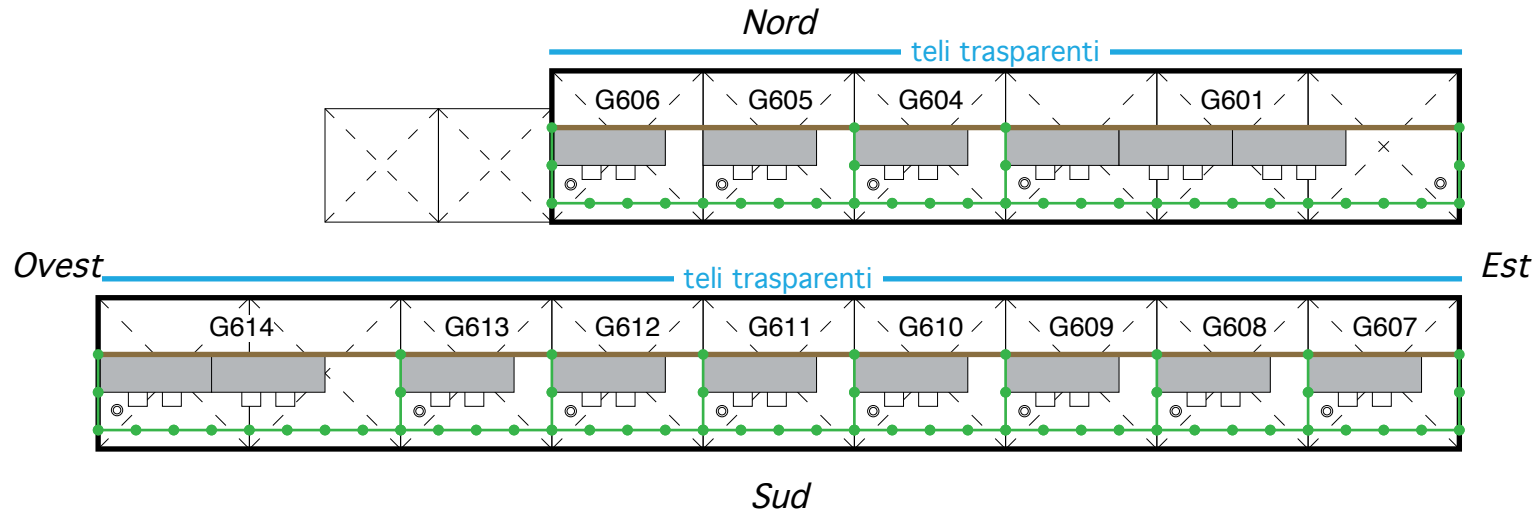
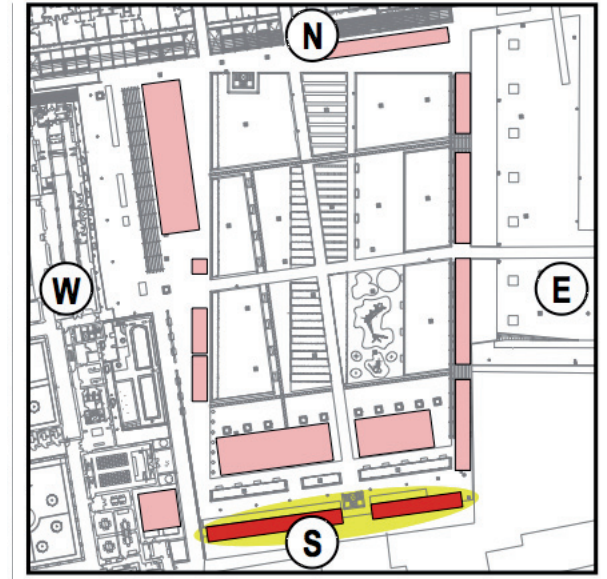



29 ott. - 1 nov. 2015
29 7 Pad. Japan Ovest
ALLEGATO GARA STAND

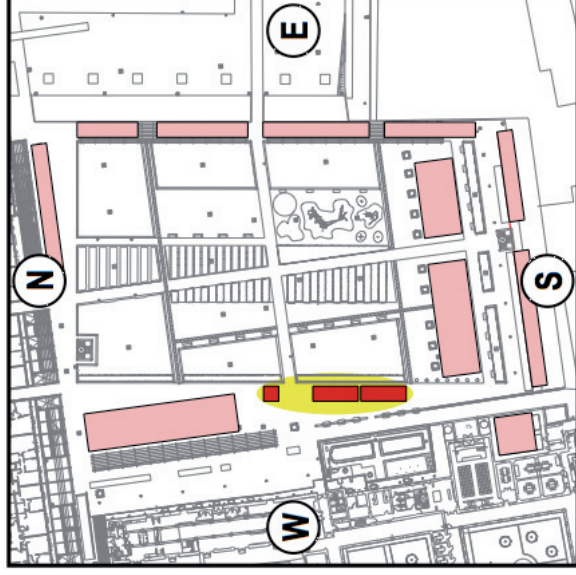

Nord

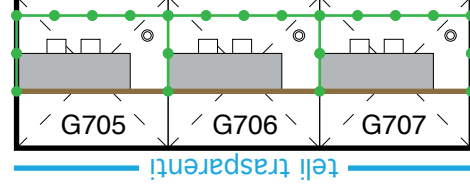
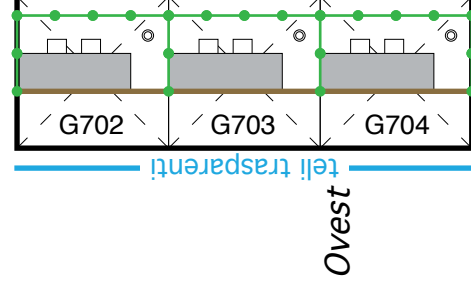
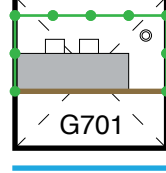

Lucca Comics & Games



29 ott. - 1 nov. 2015
29 8 Pad. Mangiappone

ALLEGATO GARA STAND

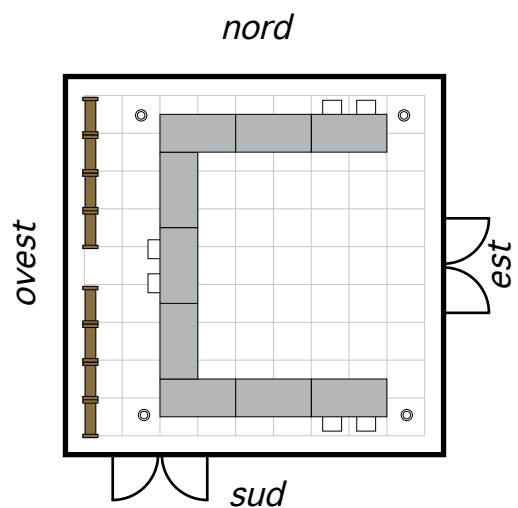
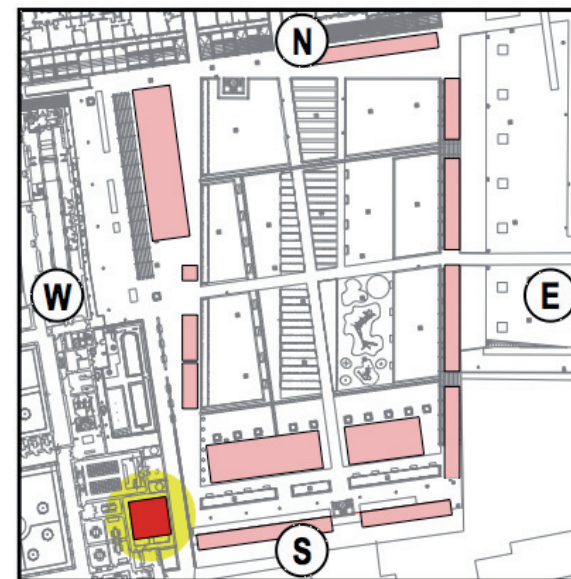

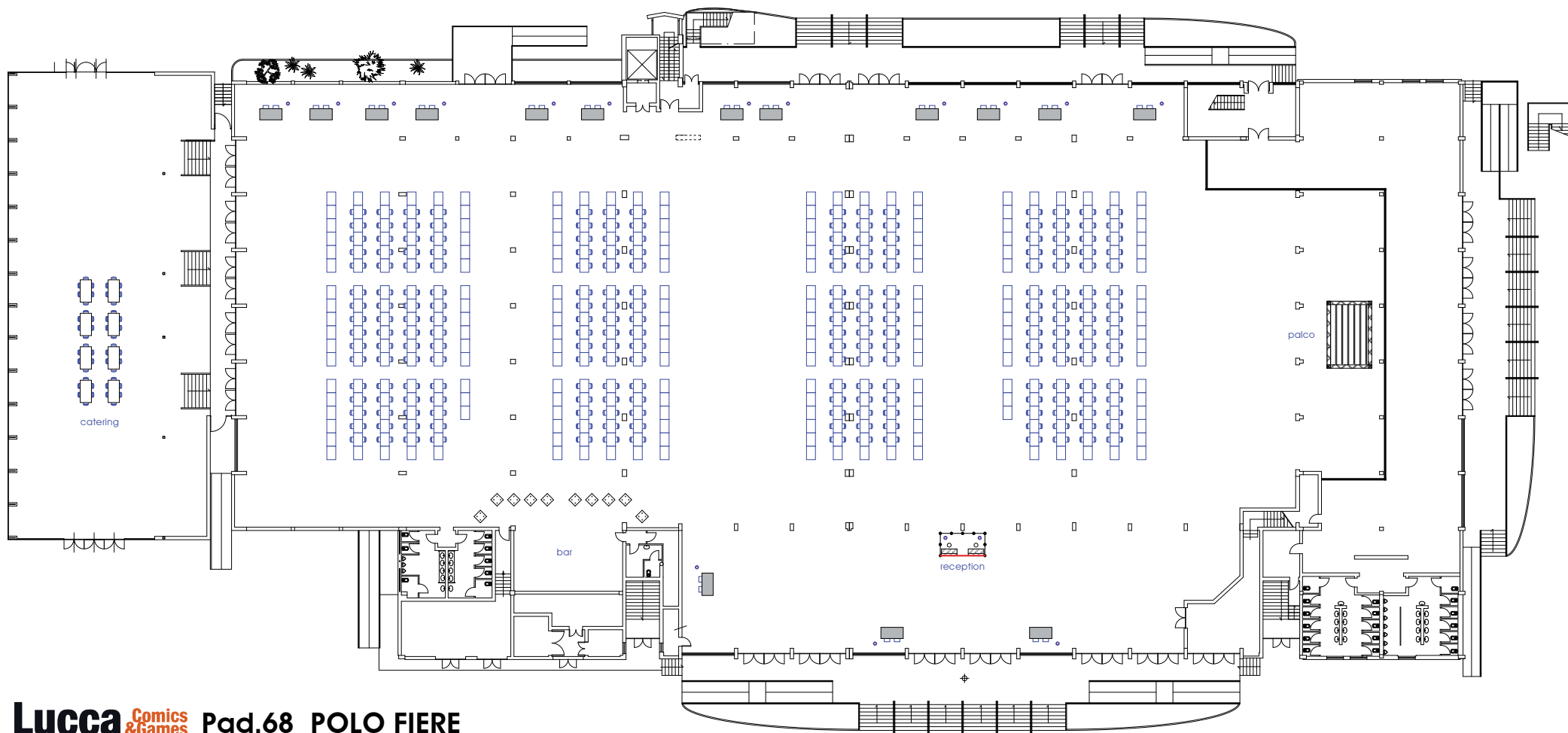

Lucca Comics & Games Pad.68 POLO FIERE



29 ott. - 1 nov. 2015

ALLEGATO GARA STAND



29 ott. - 1 nov. 2015

ALLEGATO GARA STAND

- 00 PADIGLIONI ESPOSITIVI**
 - 1 Napoleone
 - 2 Passaglia
 - 3 Giglio
 - 4 S.Giovanni
 - 5 S.Martino 1
 - 6 S.Martino 2
 - 7 S.Martino 3
 - 8 Garibaldi 1
 - 9 Garibaldi 2
 - 10 Garibaldi 3
 - 11 Garibaldi 4
 - 12 S.Romano
 - 15 S.Maria 1
 - 16 S.Maria 2
 - 17 S.Paolino (Palco)
 - 18 S.Paolino (Padiglione)
 - 19 Cortina 1
 - 20 Cortina 2
 - 21 S.Donato
 - 22 Carducci
 - 28 S.Francesco
 - 29 Giardino degli Osservanti
 - 31 Middle

- X BIGLIETTERIE E SERVIZI**
 - A** Biglietteria Verdi
 - B** Biglietteria S.Maria
 - C** Biglietteria Bacchettoni
 - D** Biglietteria Stazione
 - E** Biglietteria S.Concordio
 - F** Punto Accredito
 - G** Centro Operativo Pro.Civ.

- 00 STRUTTURE PER EVENTI**
 - 56 Chiesa dei Servi
 - 67 Villa Gioiosa
 - 68 Polo Fiore

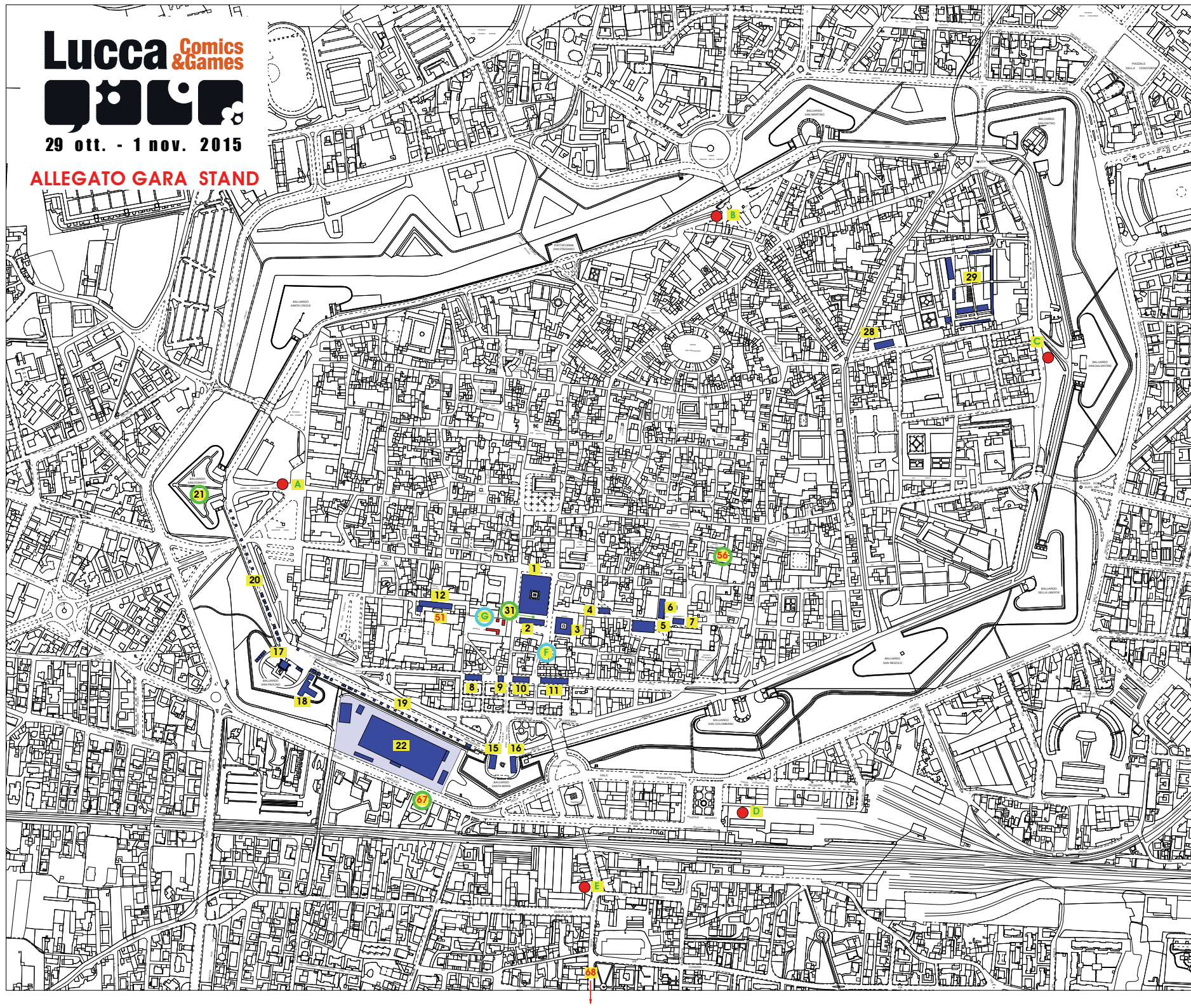

Lucca Comics & Games



29 ott. - 1 nov. 2015

Punto Accredito Comics
Rif. "F" Plan Gen COMICS

ALLEGATO GARA STAND

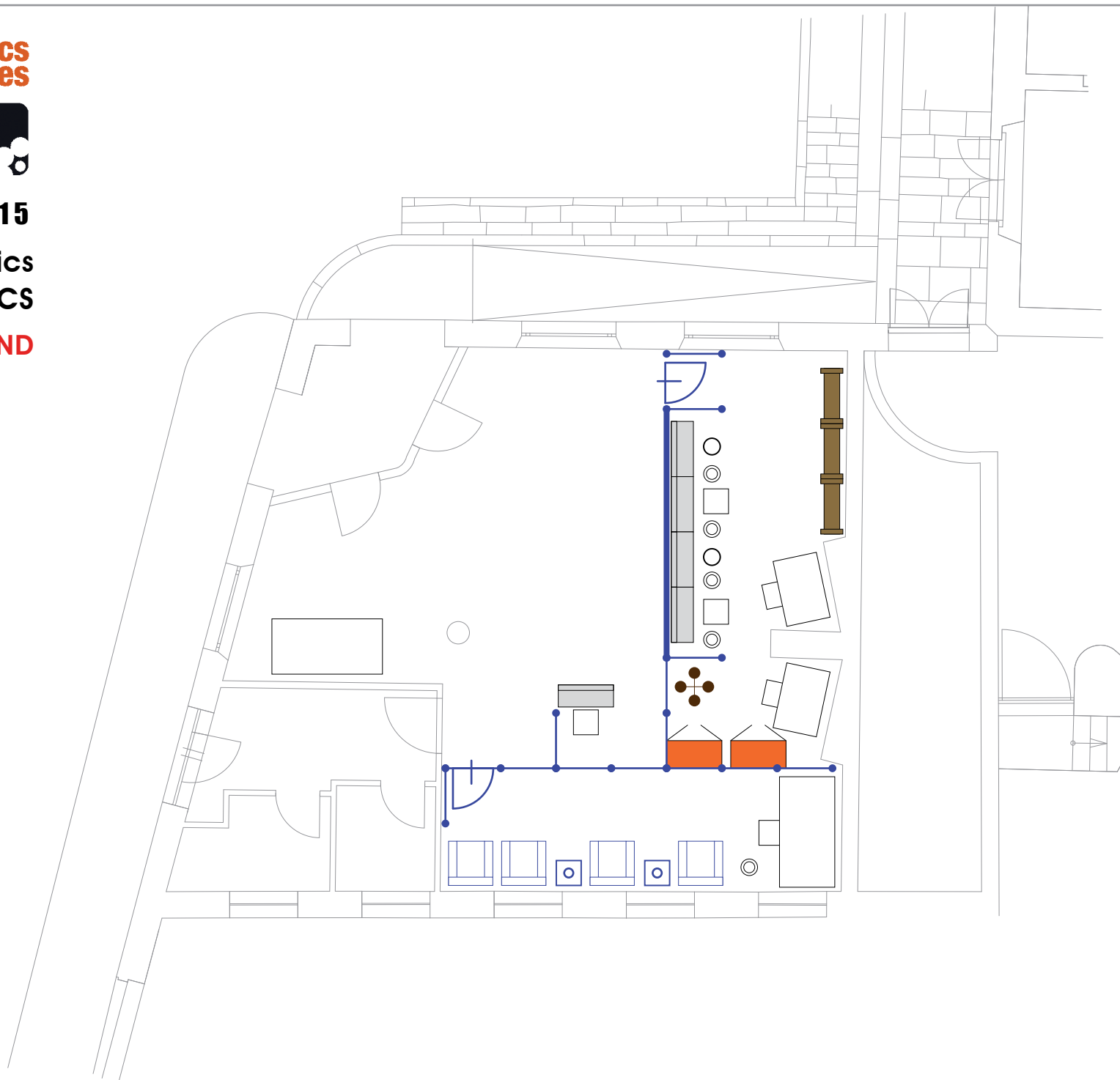

Via della Corticella

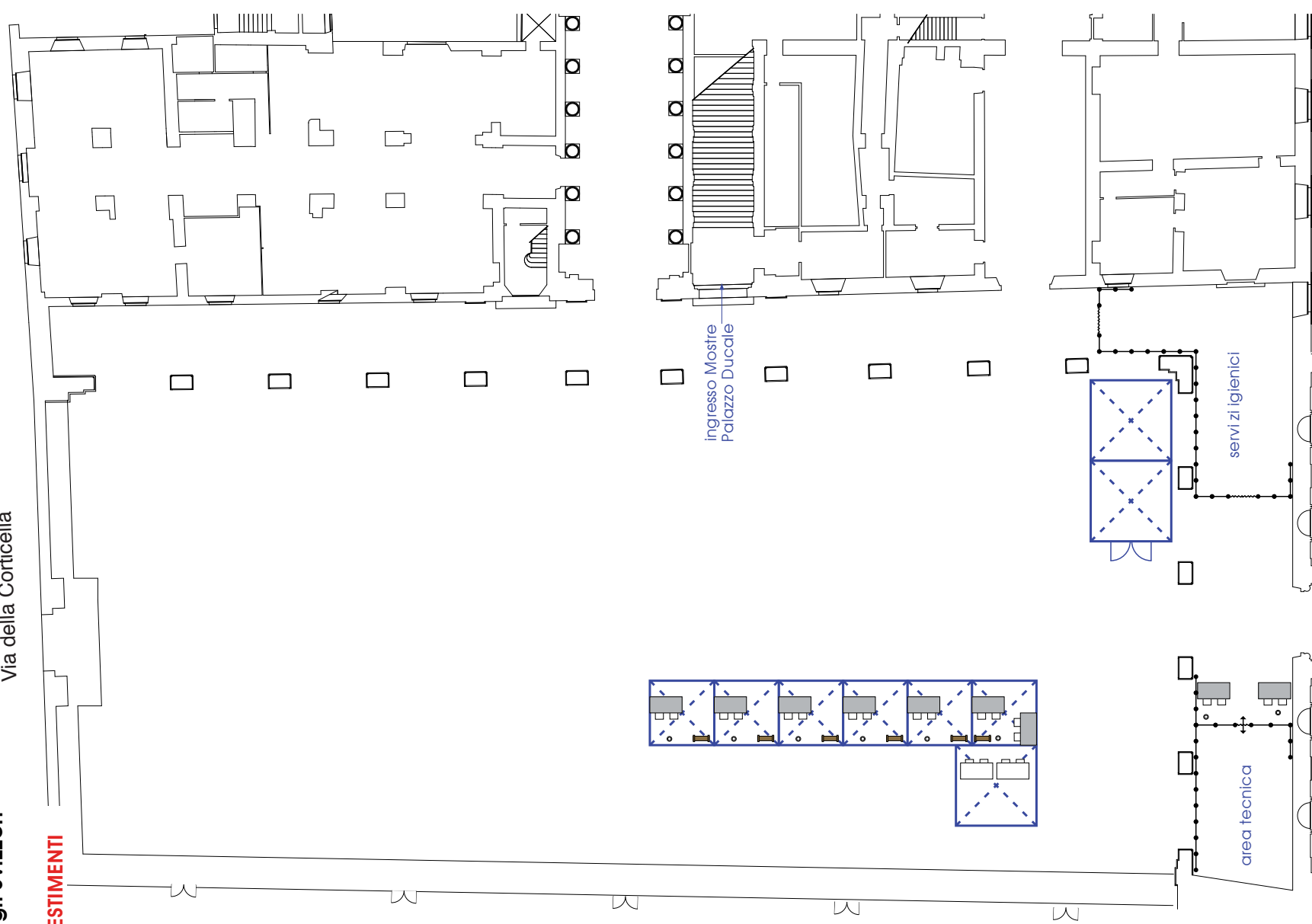

Piazza Napoleone

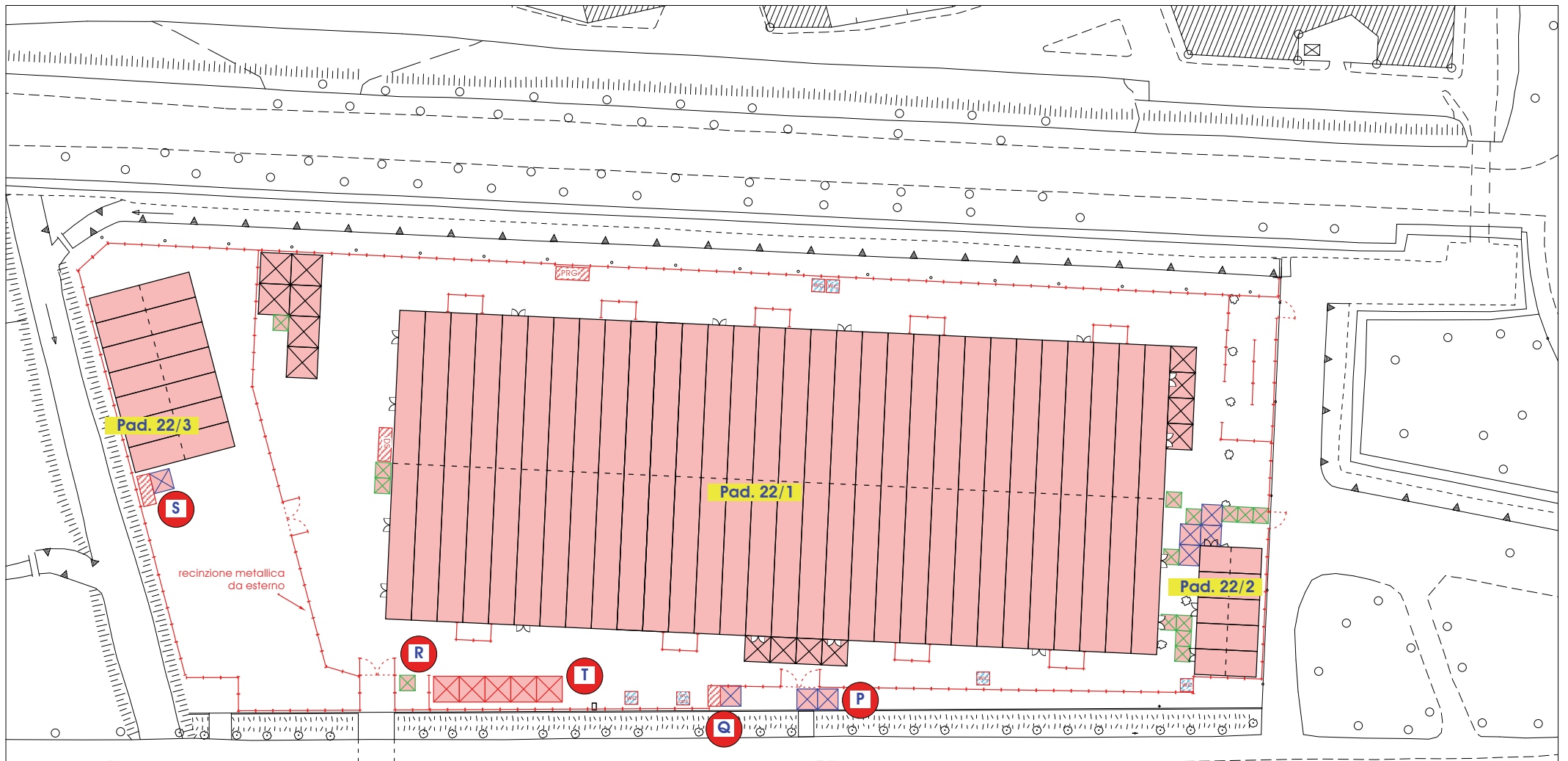

29 ott. - 1 nov. 2015

Pad. 22 Carducci area ex Campo Balilla

ALLEGATO GARA STAND

STRUTTURE

- | | | |
|---------------------|-----------------------|------------------------|
| Pad.1 Esposizione | P Controllo biglietti | R Ingresso merci |
| Pad.2 Sala Incontri | Q Punto Accredito | S Segreteria Magazzino |
| Pad.3 Magazzino | | T Punto Ristoro F.Food |